

Galleries

Gallery of Craft and Design

Exhibitions

Manchester International Festival:
11 rooms – Group show
10–17 July

Ford Madox Brown: Pre-Raphaelite Pioneer
24 September 2011–29 January 2012

Family Activities

Touch Trail

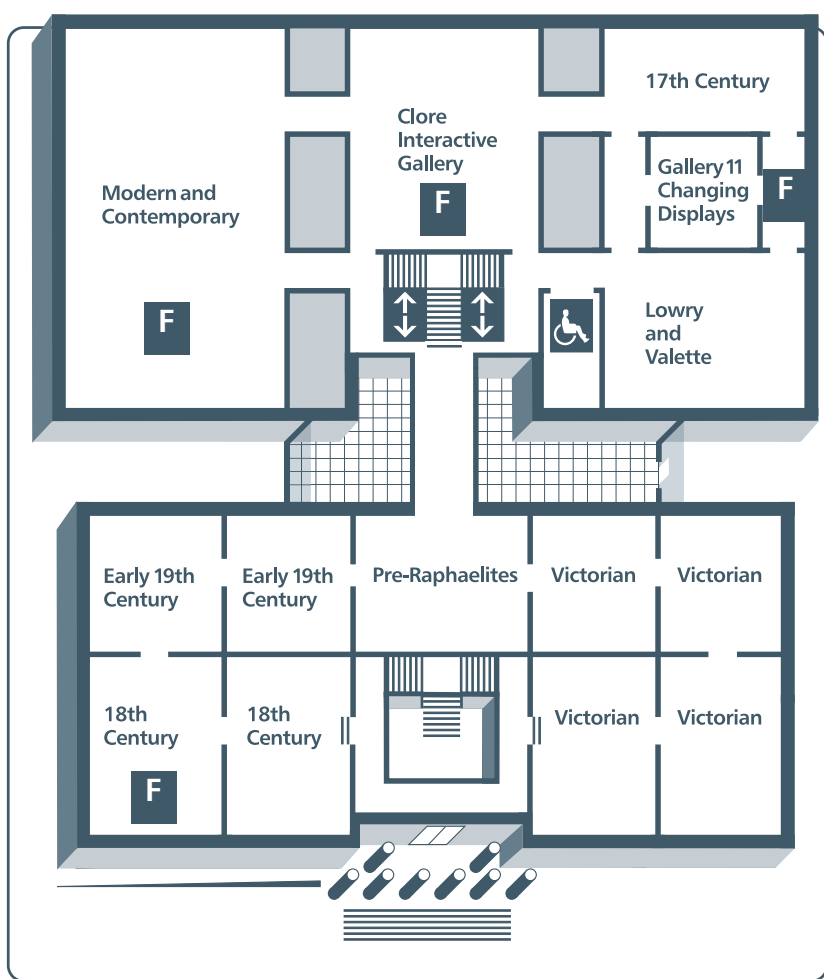

Galleries

Impressionists and Edwardian
Lowry and Valette
Modern and Contemporary
Pre-Raphaelites
Victorian
17th Century
18th Century
Early 19th Century

Gallery 11
Visual Dialogues: Grayson Perry
Until 11 Feb 2012

Gallery 6
The Pre-Raphaelite Experiment
Until May 2012

Family Activities

Interactive Gallery
Gods and Goddesses of Greece
and Rome Game
Roger Fry Jigsaw

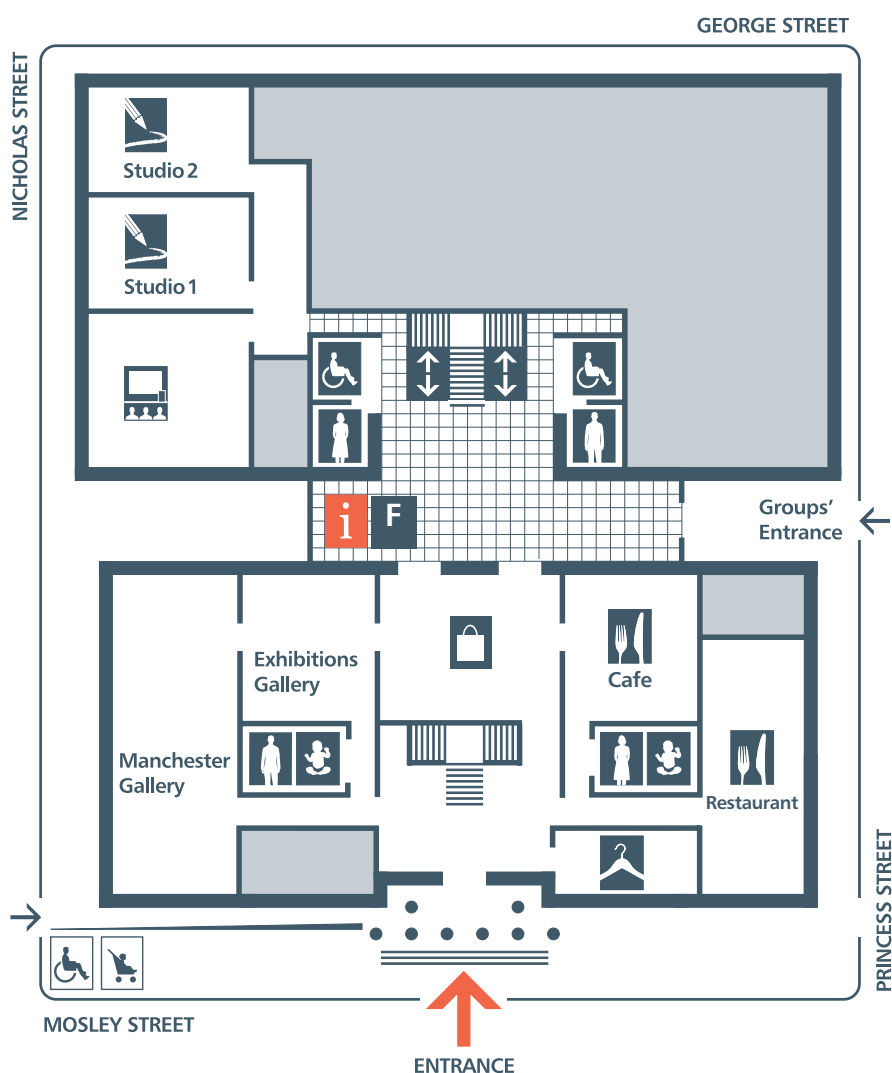

Exhibitions

Exporting Beauty:
Pilkington's Pottery and Tiles
Until 9 October 2011

Family Activities

Audio Guides
Explorer Tool Belts
Story and Activity Bags
Trails and Drawing Materials

- | | |
|---------------------|-----------------|
| Restaurant and Cafe | Lift |
| Cloakroom | Shop |
| Education Studios | Toilets |
| Information | Baby Change |
| Lecture Room | Family activity |

Hello

Here, you'll find everything from historic paintings to contemporary design. So whether you've got 10 minutes, all day, are on your own or have the children with you, welcome. There's no 'right' way around (and you certainly don't have to like everything inside).

Explore

Three floors. 21 rooms.
Over 25,000 items.
There's something for everyone.
Just wander, borrow a free audio guide or pick up one of our free collections highlights leaflets from the information desk.



Enjoy

Don't miss *Far, Far Away: A world of stories* for families, 2–26 August, 1–3pm. Work with artists to build imaginary worlds and bring stories to life in dance and drama workshops.

There are always special activities for families during school holidays and often at weekends too.

You can always enjoy real artworks and hands-on activities in the Interactive Gallery. Borrow a free story bag or explorer tool belt or follow a Heroes and Monsters trail.

Open

Tuesday–Sunday and Bank Holiday Mondays, 10am–5pm

Closed

Monday, except Bank Holidays, 1 January, Good Friday, 24–26 and 31 December



Discover

Information panels in every room tell you more about works from the collection. The new touchscreen in the entrance hall has information about the architecture of the gallery as well as some of the artworks on display.

Access for everyone

We do everything we can to make our gallery accessible for all visitors. Ask at the gallery information desk for more details.

Got a question?

Just ask a member of staff.

Support us

Admission to the collection is free but a £3 donation (or more) would really help. Please remember to Gift Aid any contribution. You can also support the gallery on a regular basis by becoming a Friend. Ask at the information desk.



Catch

See *11 Rooms*, especially commissioned for Manchester International Festival, 10–17 July. A group exhibition of performance art curated by Hans Ulrich Obrist and Klaus Bisenbach, featuring leading contemporary international artists.

Don't miss our major show *Ford Madox Brown: Pre-Raphaelite Pioneer* 24 September–29 January. It's the first exhibition of his work since 1964 and features 140 paintings and drawings. Tickets £8/£6

Above: *The Pretty Baa Lambs*, 1851–59, Ford Madox Brown
© Birmingham Museums & Art Gallery



Relax

Recharge and refresh yourself in our cafe. Everything is made downstairs in our gallery kitchen from hot meals and freshly baked cakes to salads and sandwiches. Free Wi-Fi.

The gallery shop stocks a great range of books, prints, postcards and gifts inspired by our exhibitions and collections.

All proceeds from purchases help support the gallery.

Manchester Art Gallery
Mosley Street
Manchester M2 3JL
Tel: 0161 235 8888
Fax: 0161 274 7144
Textphone: 0161 235 8893
www.manchestergalleries.org

Owned and managed by Manchester City Council

Welcome

Enjoy

Discover

Relax

Manchester Art Gallery